

907.2.9 GROUP R-2
FIRE ALARM SYSTEMS AND SMOKE ALARMS SHALL BE INSTALLED IN GROUP R-2
OCCUPANCIES AS REQUIRED IN SECTIONS 907.2.9.1 AND 907.2.9.3.

907.2.11.2 GROUPS R-2, R-3, R-4 AND I-1.
SINGLE- OR MULTIPLE-STATION SMOKE ALARMS SHALL BE INSTALLED AND MAINTAINED IN GROUPS R-2, R-3, R-4 AND I-1 REGARDLESS OF OCCUPANT LOAD AT ALL OF THE FOLLOWING LOCATIONS:

- 907.5.2 ALARM NOTIFICATION APPLIANCES.
ALARM NOTIFICATION APPLIANCES SHALL BE PROVIDED AND SHALL BE LISTED FOR THEIR PURPOSE.

1. THE INTERCONNECTION OF THE BUILDING FIRE ALARM SYSTEM WITH THE UNIT SMOKE ALARMS.
2. THE REPLACEMENT OF AUDIBLE APPLIANCES WITH COMBINATION AUDIBLE/VISIBLE APPLIANCES.
3. THE FUTURE EXTENSION OF THE EXISTING WIRING FROM THE UNIT SMOKE ALARM LOCATIONS TO REQUIRED LOCATIONS FOR VISIBLE APPLIANCES.

ALL DWELLING UNITS SHALL BE EQUIPPED WITH THE CAPABILITY TO INCORPORATE AND SUPPORT ALARM NOTIFICATION APPLIANCES AS PER THE REQUIREMENTS OF SECTION 907.9.1.4 FLORIDA BUILDING CODE F.B.C. 7TH EDITION (2020)

- TOTAL BUILDING AREA:
- | | | |
|---------|---------------|-----|
| 1ST FL: | <u>6,998</u> | S.F |
| 2ND FL: | <u>6,998</u> | S.F |
| 3RD FL: | <u>6,998</u> | S.F |
| TOTAL: | <u>20,994</u> | S.F |

- OCCUPANCY TYPE:
R-2 MULTI-FAMILY DWELLING
PER FBC 7TH EDITION (2020) SECTION 310

- NO. OF STORIES: 4 (ALLOWED)
3 (PROVIDED)

- 1) A/C BUILDING AREA:
- | | | |
|---------|---------------|-----|
| 1ST FL: | <u>5,496</u> | S.F |
| 2ND FL: | <u>5,496</u> | S.F |
| 3RD FL: | <u>5,496</u> | S.F |
| TOTAL: | <u>16,488</u> | S.F |

NOTE:
ALLOWABLE HEIGHT AND BUILDING AREAS PER
TABLE 504.3 & 506.2 FLORIDA BUILDING CODE 7TH EDITION
(2020).

303 CHANGES IN LEVEL

CHANGES IN LEVEL OF 1/4 INCH (6.4 MM) HIGH MAXIMUM SHALL BE PERMITTED
VERTICAL.

307 PROTRUDING OBJECTS

EXCEPTION: HANDRAILS SHALL BE PERMITTED TO PROTRUDE 4 1/2 INCH (114 MM) MAXIMUM.

CIRCULATION PATHS 12 INCHES (305 MM) MAXIMUM WHEN LOCATED 27 INCHES (685 MM) MINIMUM AND 80 INCHES (2030 MM) MAXIMUM ABOVE THE FINISH FLOOR OR GROUND. WHERE A SIGN OR OTHER OBSTRUCTION IS MOUNTED BETWEEN POSTS OR PYLONS AND THE CLEAR DISTANCE BETWEEN THE POSTS OR PYLONS IS GREATER THAN 12 INCHES (305 MM), THE LOWEST EDGE OF SUCH SIGN OR OBSTRUCTION SHALL BE 27 INCHES (685 MM) MAXIMUM OR 80 INCHES (2030 MM) MINIMUM ABOVE THE FINISH FLOOR OR GROUND.

307.4 VERTICAL CLEARANCE.
VERTICAL CLEARANCE SHALL BE 80 INCHES (2030 MM) HIGH MINIMUM. GUARDRAIL OR OTHER BARRIERS SHALL BE PROVIDED WHERE THE VERTICAL CLEARANCE IS LESS THAN 80 INCHES (2030 MM) HIGH. THE LEADING EDGE OF SUCH GUARDRAIL OR BARRIER SHALL BE LOCATED 27 INCHES (685 MM) MAXIMUM ABOVE THE FINISH FLOOR OR GROUND.

307.5 REQUIRED CLEAR WIDTH.
PROTRUDING OBJECTS SHALL NOT REDUCE THE CLEAR WIDTH REQUIRED FOR
ACCESSIBLE ROUTES.

--	--

1. DO NOT SCALE DRAWINGS USE FIGURE DIMENSIONS ONLY, CONTRACTOR SHALL VERIFY ALL DIMENSIONS AND CONDITIONS, IN THE EVENT OF A CONFLICT NOTIFY ARCHITECT BEFORE PROCEEDING.
2. BUILDING FOOTPRINT SHOWN FOR DIMENSION AND NOTES PURPOSE ONLY, REFER TO SITE PLAN FOR ACTUAL BUILDING ORIENTATION.
3. REFER TO CIVIL DRAWINGS AND ARCHITECTURAL SITE PLAN FOR SIDEWALKS CONTINUATION. EXTERIOR WALKWAYS TO BE SLOPED AWAY FROM THE BUILDING ENTRANCES AT 1 TO 20 SLOPE (REFER TO CIVIL GRADING PLANS).
4. SOIL TO BE TREATED FOR TERMITES BEFORE POURING SLABS.GENERAL CONTRACTOR TO PROVIDE TO THE BUILDING DEPARTMENT A CERTIFICATE OF COMPLIANCE PREPARED BY A LICENSED PEST CONTROL COMPANY THAT CONTAINS THE FOLLOWING STATEMENT:"THE BUILDING HAS RECEIVED A COMPLETE TREATMENT FOR THE PREVENTION OF SUBTERRANEAN TERMITES, TREATMENT IS IN ACCORDANCE WITH RULES AND LAWS ESTABLISHED BY THE FLORIDA DEPARTMENT OF AGRICULTURE AND CONSUMER SERVICES" PER F.B.C. 7TH EDITION (2020) SECTION 1816.1.7
5. STORAGE AREA UNDER STAIRS FOR ELECT. CLOSETS ONLY.
6. REFER TO TABLES 601 & TABLE 602 ON SHEET A0.04 FOR BUILDING FIRE PROTECTION.
7. REFER TO ARCHITECTURAL SITE PLAN FOR ELECTRICAL ROOM, TELEPHONE/CABLE ROOM AND FIRE SPRINKLER CABINET LOCATION AND ORIENTATION.
8. EACH BUILDING SHALL HAVE ITS OWN FIRE ALARM CONTROL PANEL FOR OCCUPANCY NOTIFICATION AND MONITORING OF THE FIRE SPRINKLER SYSTEM (SEE FIRE PREVENTION DOCUMENTS).
9. BUILDINGS TO BE EQUIPPED THROUGHOUT WITH AN APPROVED AUTOMATIC SPRINKLER SYSTEM IN ACCORDANCE WITH F.B.C. 2020 7TH EDITION, SECTION 903.3.1.2 (SEPARATE PERMIT REQUIRED).
10. REFER TO SITE PLAN & ELECTRICAL DWGS FOR HEARING-IMPAIRED UNIT LOCATIONS.
11. ALL FIRE RATED TENANT SEPARATIONS FROM SLAB TO SLAB, ALL FIRE AND SMOKE BARRIER PENETRATIONS TO BE PROTECTED.
12. PROVIDE PERMANENTLY IDENTIFIED WITH SIGNS OR STENCILING IN A MANNER ACCEPTABLE TO THE AUTHORITY HAVING JURISDICTION IN ACCORDANCE WITH THE FLORIDA BUILDING CODE, SECTION 713.6 "FIRE WALLS, FIRE BARRIERS, FIRE PARTITIONS, SMOKE BARRIERS AND SMOKE PARTITIONS OR ANY OTHER WALL REQUIRED TO HAVE PROTECTED OPENINGS SHALL BE EFFECTIVELY AND PERMANENTLY IDENTIFIED WITH SIGNS OR STENCILING IN A MANNER ACCEPTABLE TO THE AUTHORITY HAVING JURISDICTION. SUCH IDENTIFICATION SHALL BE ABOVE ANY DECORATIVE CEILING AND IN CONCEALED SPACES. SUGGESTED WORDING FOR FIRE AND SMOKE BARRIERS: "FIRE AND SMOKE BARRIER – PROTECT ALL OPENINGS."
13. LANDINGS SUBJECT TO WET CONDITIONS SHALL BE CONSTRUCTED TO PREVENT THE ACCUMULATION OF WATER (PER FBCE SEC. 405.10)

DOOR DESIGNATION

	<p>F.E. PROVIDE FIRE EXT. 2A 40BC TYPE (FIRE EXTINGUISHER TO COMPLY W/F.B.C. CHAPTER 36 F.F.P.C. 7.6.3.1 & N.F.P.A 10) MAXIMUM TRAVEL DISTANCE TO A FIRE EXTINGUISHER – 75 FT FOR ORDINARY HAZARD AREAS. FIRE EXTINGUISHERS SHOULD BE MOUNTED MINIMUM 4 INCHES AND MAXIMUM 5FT FROM FLOOR IF FIRE EXTINGUISHER IS LESS THAN 40LB IN WEIGHT.</p>
---	---

ALL INSULATION MATERIALS TO HAVE A FLAME SPREAD INDEX OF NOT MORE THAN 25 AND A SMOKE-DEVELOPED INDEX OF NOT MORE THAN 450. PER FBC 7th EDITION (2020), SECT 719.2

[illegible]

2203

GATEWAY LUXURY APARTMENTS

LOCATED AT:
950 N POWERLINE ROAD,
POMPANO BEACH FL 33069

BURGOS LANZA & ASSOCIATES
1248 S ALHAMBRA CIRCLE
CORAL GABLES, FL 33146
(786) 554-9035
AIA 38052598
WWW.BURGOSLANZA.COM
PABLO BURGOS ARCHITECT AR 0095925
CARLOS LANZA ARCHITECT AR 0016081
S LANZA ARCHITECTS AND ARE
EXPRESS WRITTEN CONSENT OF THE SAME

**BURGOS
LANZA**
ARCHITECTS & PLANNERS
AA 26001519

COPYRIGHT 2021, BURGOS, LANZA & ASSOCIATES
ALL RIGHTS RESERVED. NO PARTS OF THIS PUBLICATION
OR INSTRUMENTS OF SERVICE NOT TO BE REPRODUCED IN ANY
MANNER WITHOUT THE WRITTEN PERMISSION OF BURGOS, LANZA & ASSOCIATES

Pablo Burgos

Digitally signed by Pablo Burgos
DN: cn=Pablo Burgos, o=Burgos
Lanza & Assoc., ou=AR95925,
email=pburgos@burgoslanza.co
m, c=US
Date: 2022.05.11 14:32:02 -04'00'

DATE	11/09/21
DRAWN	CR
PROJECT No.	2203
SCALE	AS-SHOWN

GROUND FLOOR
BUILDING 12
SCALE 1/8" = 1' - 0"
A1 21

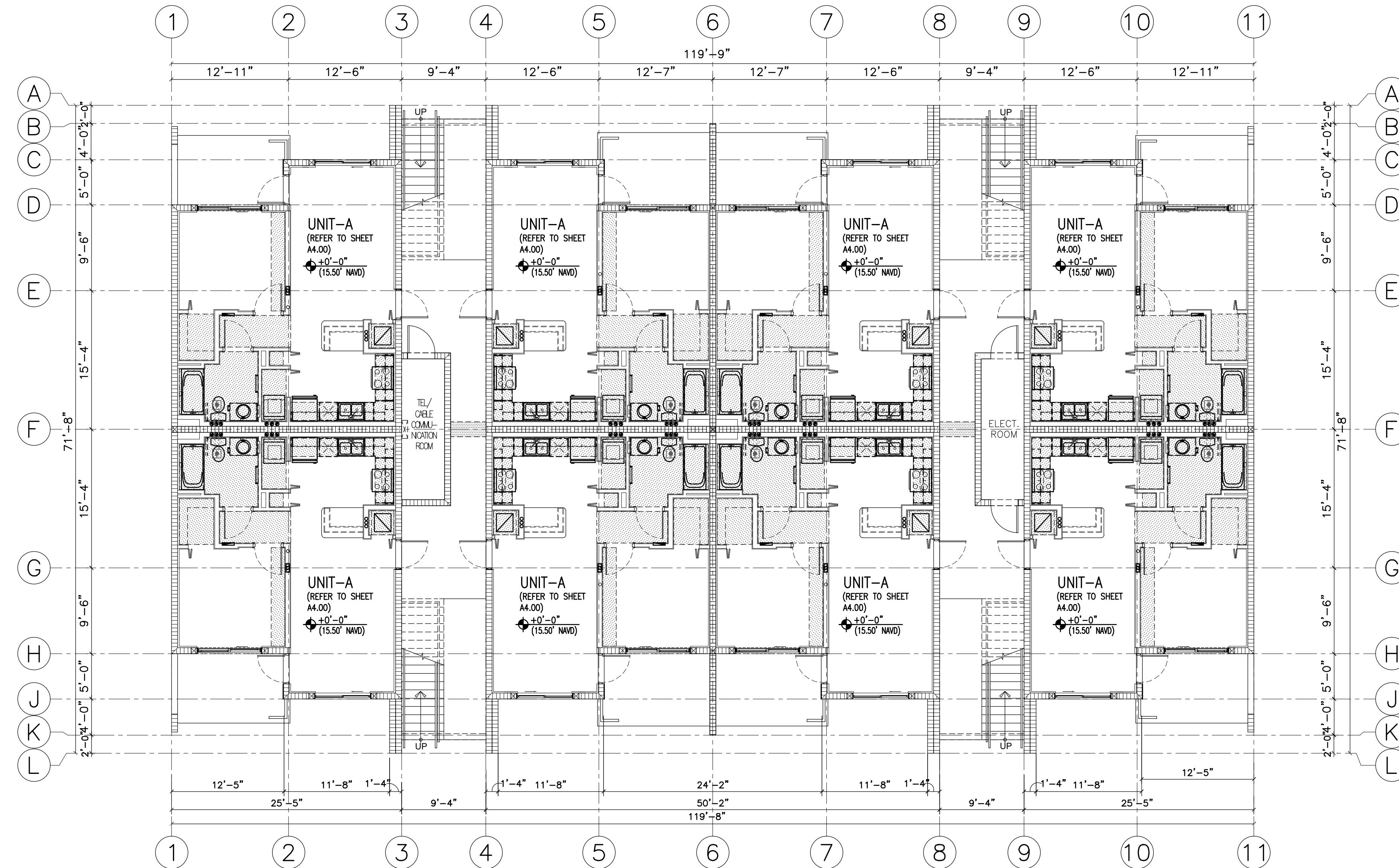

GROUND FLOOR PLAN BUILDING #2

SCALE: 1/8" = 1'-0"

DRC
PZ22-120000008
6/15/2022